

Note: Part numbers and standards' values may change. Consult LECO for the latest information.

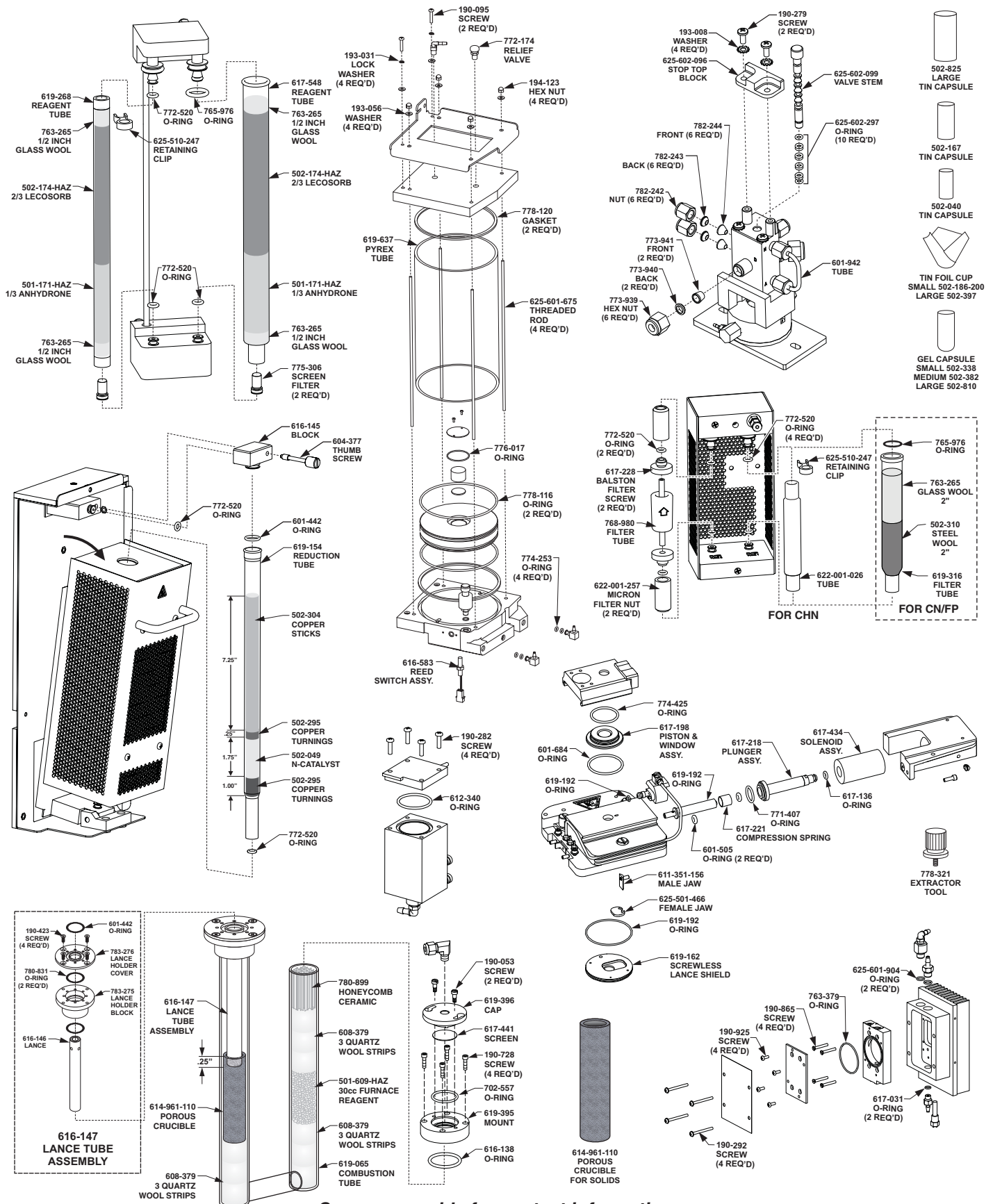

See reverse side for contact information

GENERAL COMBUSTION SUPPLIES

501-171-HAZ Anhydrous 454 g (1 lb.) bottle
 502-189 Copper Sticks 100 g ampule
 502-304 Copper Sticks 100 g bottle
 502-304-500 Copper Sticks 500 g bottle
 502-295 Copper Turnings 100 g bottle
 501-081 Glass Wool 454 g (1 lb.) box
 763-265 Glass Wool 227 g (0.5 lb.) package
 502-174-HAZ Lecosorb 500 g bottle
 502-049 N-Catalyst 50 g bottle
 608-379 Quartz Wool Strips 10/pkg
 502-310 Steel Wool 454 g (1 lb.)
 501-609-HAZ Furnace Reagent
 625-602-470 Ballast C-Flex
 Replacement Assembly

CAPSULES AND CRUCIBLES

502-338 Gel Capsule, Small 400/pkg
 502-382 Gel Capsule, Medium 400/pkg
 502-810 Gel Capsule, Large 400/pkg
 614-961-110 Porous Crucibles for solids 10/pkg
 617-605 Porous Crucibles for liquids 10/pkg
 502-040 Tin Capsules, Small 100/bottle
 502-040-100 Tin Capsules, Small 1000/bottle
 502-167 Tin Capsules, Medium 100/bottle
 502-825 Tin Capsules, Large 50/bottle
 502-186-200 Tin Foil Cups, Small 100/bottle
 502-186-100 Tin Foil Cups, Small 1000/bottle
 502-397 Tin Foil Cups, Large 100/bottle
 502-397-400 Tin Foil Cups, Large 400/bottle

OPERATION ACCESSORIES

502-007 Tube Cleaner
 601-981 Wire Brush
 616-152 Crucible Extractor Tool
 775-306 Secondary Filter, 10 micron
 775-307 Filter Tool, Thumbscrew
 502-023 Funnel Quick Disc
 778-321 Lance Extraction Tool
 502-213 Leak Detection Solution
 601-470-110 Liquid Injector Kit, Manual
 762-515 O-ring Tool - Removal
 616-513 O-ring Tool - Installation
 616-504 Particle Filter
 604-398 Sample Cup Holder, Large
 604-373 Sample Cup Holder, Small
 601-490-110 Sample Foiler Kit
 778-405 10-Sample Storage Block
 501-614 Spatula
 619-180-110 Stackable Carousel Assembly
 502-028 Tweezers
 604-378 Tweezers, Curved (SST)
 501-241 Vacuum Grease
 619-380 Vacuum Cleaner Attachment Assembly
 619-377 Bypass Plate

COMBUSTION TUBES AND GLASSWARE

601-390 Glass Filter Tube (wide mouth top, small bottom)
 requires one (1) 765-976 Top O-ring and one (1)
 772-520 Bottom O-ring for sealing
 622-001-026 Glass Filter Tube (small mouth top and bottom)
 requires 772-520 O-rings for sealing
 619-268 Reagent Tube, requires 772-520 O-rings for sealing
 619-154 Reduction Tube, requires 601-442 O-rings for sealing
 780-899 Honeycomb Ceramic Stop
 619-065 Combustion Tube
 617-441 Screen Filter
 617-548 Reagent Tube, requires 765-976 Top O-ring
 and 772-520 Bottom O-ring for sealing

*Values vary—contact LECO for current levels.

NOTE: Part numbers and standards' values may change.
 Consult LECO for latest information.

Natural Matrix Set-Up Standards

Part No.	Description	% C	% H	% N	% S	Contents
501-561-150	Soy Flour	—	—	8.0–10.0	—	50 g
501-563-150	Corn Flour	—	—	0.8–1.6	—	50 g
502-055	Orchard Leaves	44.0–52.0	5.7–6.5	2.0–2.8	0.15–0.25	20 g
502-082	Tobacco Leaves	35.0–47.0	4.0–7.0	2.0–4.0	0.3–0.8	20 g
502-272	Corn Gluten	51.0–53.0	7.0–7.5	11.0–12.0	0.75–1.0	50 g
502-273	Alfalfa	45.0–47.0	5.5–6.5	2.5–5.0	0.25–0.35	50 g
502-274	Wheat Flour	44.0–46.0	6.0–7.0	2.5–3.5	0.15–0.25	50 g
502-275	Rye Flour	43.5–45.5	6.0–7.0	1.5–2.5	0.10–0.20	50 g
502-276	Oat Meal	45.0–47.0	6.0–7.0	2.5–3.5	0.15–0.25	50 g
502-277	Barley	45.0–47.0	6.0–7.0	1.0–3.0	0.10–0.20	50 g
502-278	Rice Flour	43.0–45.0	6.0–7.0	1.0–3.0	0.10–0.20	50 g

Pure Chemical Set-Up Standards

Part No.	Description	% C	% H	% N	% O	Contents
501-050	Nicotinic Acid	58.53	4.09	11.38	—	15 g
502-092	EDTA	40.80–41.20	5.46–5.54	9.52–9.60	—	50 g
502-211	Glycine	32.00	6.71	18.66	42.63	50 g
502-642	Phenylalanine	65.4	6.7	8.5	—	50 g

Coal and Coke Reference Materials

Part No.	Description	% Sulfur	% C	% H	% N	Contents
502-680	Coal Prox Plus Low	~0.3	~81.0	~4.0	~1.0	50 g
502-681	Coal Prox Plus Med.	~1.3	~78.0	~5.0	~1.5	50 g
502-682	Coal Prox Plus High	~0.5	~75.0	~5.0	~1.5	50 g
502-683	Met Coke Prox Plus	~0.75	~87.0	~0.3	~1.0	50 g
502-684	Pet Coke Prox Plus	~5.5	~87.0	~3.6	~1.5	50 g

CERTIFIED REFERENCE MATERIALS

Part No.	Description	% Sulfur	% C	% H	% N	Contents
502-812	EDTA CRM	—	~41.1	~5.55	~9.56	50 g
502-815	Mineral Oil CRM	—	~86.0	~13.80	—	118 ml (4 oz.)
502-816	Residual Fuel Oil	~3.0	~86.0	~10.0	~0.3	118 ml (4 oz.)